

FIG. 7 CARBURETOR (GT750K)

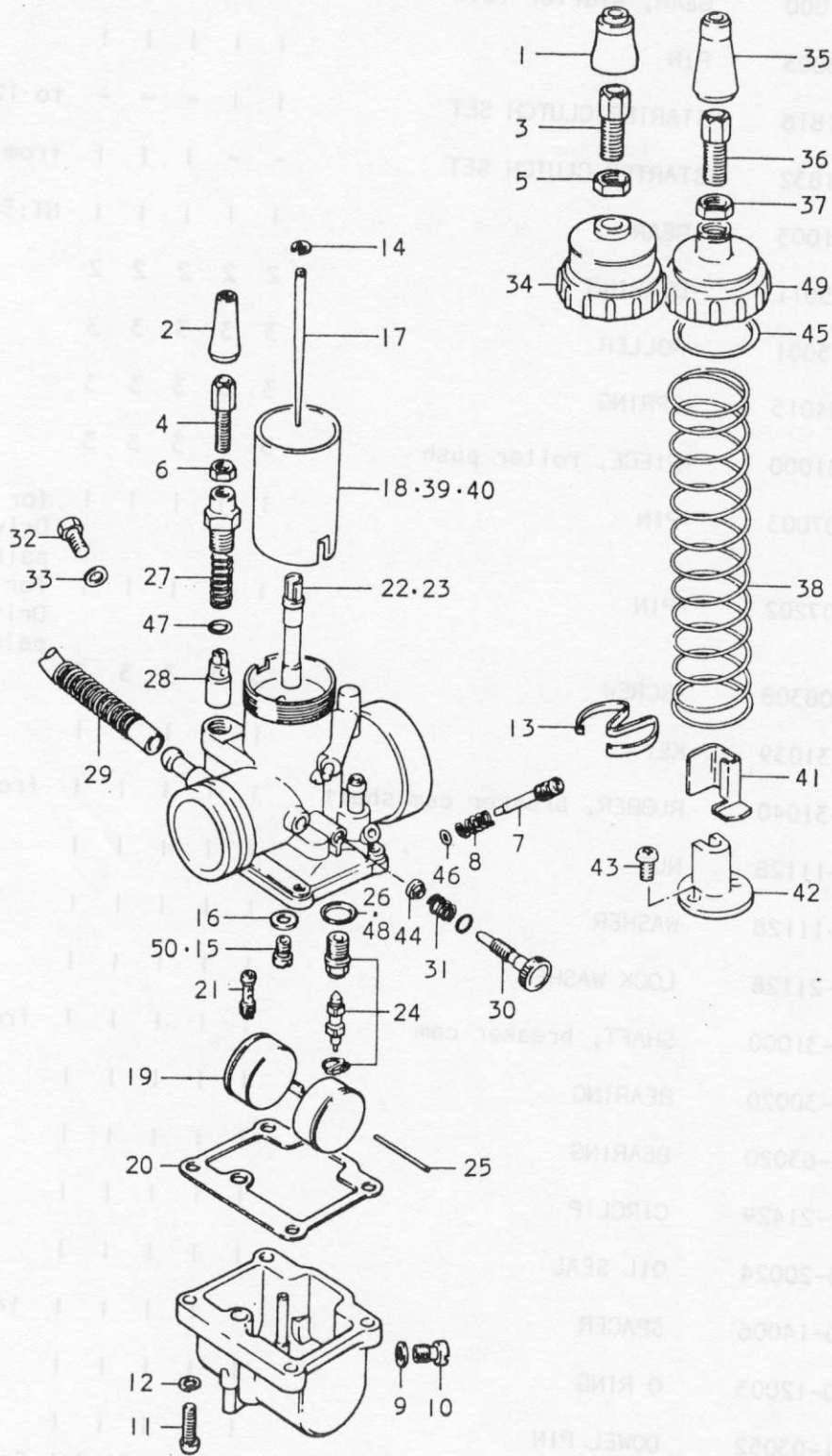

FIG.7 CARBURETOR (GT750K)

Ref.No.	Part No.	Description	Q'ty K	Remarks
	13201-31014	CARBURETOR ASSY, RH	1	to 13201-31015
	13202-31014	CARBURETOR ASSY, middle	1	press-stamped 31014 to 13202-31015
	13203-31014	CARBURETOR ASSY, LH	1	to 13203-31015
	13201-31015	CARBURETOR ASSY, RH	1	
	13202-31015	CARBURETOR ASSY, middle	1	press-stamped 31015 F.No.39101~
	13203-31015	CARBURETOR ASSY, LH	1	
1	13681-31010	•BOOT	3	
2	13681-16601	•BOOT	3	from 13681-16600
3	13577-31010	•ADJUSTER, cable	3	
4	13577-03010	•ADJUSTER, cable	3	
5	13661-31010	•NUT, cable adjuster	3	
6	13661-16600	•NUT, cable adjuster	3	
7	13269-15010	•SCREW, pilot air	3	
8	13268-01010	•SPRING, pilot air screw	3	
9	13249-05010	•GASKET, drain plug	3	
10	13247-05010	•PLUG, drain	3	
11	02111-04168	•SCREW	12	
12	08321-21048	•LOCK WASHER	12	
13	13581-15010	•SEAT, throttle valve	3	F.No. 39100~
14	13394-10010	•CLIP, needle	3	
15-1	09491-20004	•JET, main (RH & LH)	2	#102.5
15-2	09491-2003	•JET, main (middle)	1	#100

C2

FIG.7 CARBURETOR (GT750K)

Ref.No.	Part No.	Description	Q'ty K	Remarks
16	13382-03110	•WASHER	3	
17	13383-31010	•NEEDLE, jet	3	5F 16-3
18-1	13561-31012	•VALVE, throttle (LH)	1	CA:2.5
18-2	13551-31012	•VALVE, throttle (RH & Middle)	2	CA:2.5
19	13252-18010	•FLOAT	3	
20	13251-33110	•GASKET, float chamber	3	from 13251-18010
21	09492-30003	•JET, pilot	3	#30
22	09494-00051	•JET, needle (RH & LH)	2	P-4
23	09494-00095	•JET, needle (Middle)	1	P-3
24	13370-18010	•VALVE ASSY, needle	3	
25	13254-01010	•PIN, float	3	
26	13392-15010	•GASKET, valve seat	3	
27	13417-18630	•SPRING, starter valve	3	
28	13411-01010	•VALVE, starter	3	
29	44390-15050	•HOSE, boost	1	
30	13267-33010	•SCREW, throttle stop	3	
31	13268-31010	•SPRING, throttle stop screw	3	
32	13664-18654	•BOLT, valve inspection	3	from 13664-31010
33	13663-31010	•GASKET, inspection bolt	3	
34	13261-31011	•CAP, mixing chamber	3	
35	13681-16601	•BOOT	3	
36	13577-03010	•ADJUSTER, cable	3	} F.No.39101~
37	13661-16600	•NUT, cable adjuster	3	
38-1	13573-31011	•SPRING, throttle valve	3	
38-2	13573-31012	•SPRING, throttle valve	3	F.No.39101~

C3

FIG.7 CARBURETOR (GT750K)

Ref.No.	Part No.	Description	Q'ty K	Remarks
39	13561-31013	•VALVE, throttle LH	1	use for press-stamped 31015 F.No.39101~
40	13551-31013	•VALVE, throttle RH	2	
41	13394-31010	•COVER, connector	3	
42	13398-34010	•CONNECTOR	3	
43	13399-34010	•SCREW, connector	3	
44	13291-34010	•COVER, throttle stop screw	3	
45	13295-31010	•O RING	3	
46	13295-33010	•O RING	3	
47	13295-34010	•O RING	3	
48	13392-16600	•GASKET, valve seat	3	
49	13261-15111	•CAP, mixing chamber	3	
50-1	09491-97001	JET, main	3	#97.5
50-2	09491-21003	JET, main	3	#105
50-3	09491-21006	JET, main	3	#107.5
50-4	09491-22004	JET, main	3	#110
50-5	09491-22005	JET, main	3	#112.5

C4