

FIG. 21 TRANSMISSION

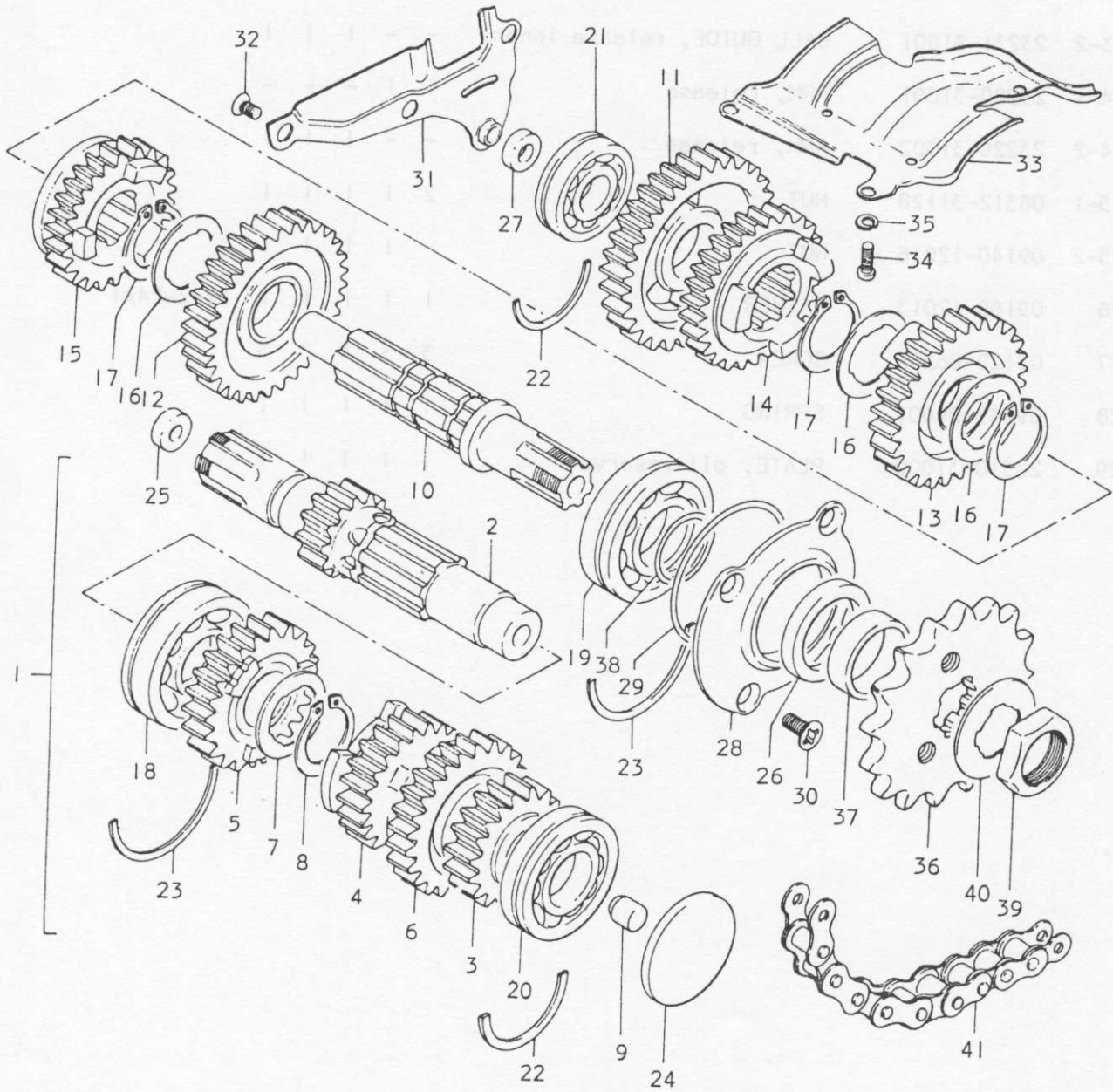

FIG.21 TRANSMISSION

Ref.No.	Part No.	Description	Q'ty					Remarks
			K	L	M	A	B	
1-1	24120-31000	COUNTERSHAFT ASSY	1	1	1	1	-	to 24120-31001 ~E.No.76849
1-2	24120-31001	COUNTERSHAFT ASSY	-	-	-	1	-	~F.No.66399 to 24120-31002 See Note 1
1-3	24120-31002	COUNTERSHAFT ASSY	-	-	-	1	-	to 24120-31003
1-4	24120-31003	COUNTERSHAFT ASSY	-	-	-	1	1	
2	24121-31000	•COUNTERSHAFT	1	1	1	1	1	NT:13
3-1	24221-31000	•GEAR, 2nd drive	1	1	1	1	-	NT:19 ~F.No.66399
3-2	24221-37000	•GEAR, 2nd drive	-	-	-	1	1	NT:18
4-1	24231-31000	•GEAR, 3rd drive	1	1	1	1	-	NT:22 ~F.No.66399
4-2	24231-37000	•GEAR, 3rd drive	-	-	-	1	1	NT:21
5-1	24240-31000	•GEAR, 4th drive	1	1	1	1	-	NT:24
5-2	24240-31001	•GEAR, 4th drive	-	-	-	1	1	NT:24
6-1	24250-31000	•GEAR, 5th drive	1	1	1	1	-	NT:26 to 24250-31001
6-2	24250-31001	•GEAR, 5th drive	-	-	-	1	1	NT:26
7	09167-28001	•WASHER	1	1	1	1	1	
8	08331-11289	•CIRCLIP	1	1	1	1	1	from 09380-28002
9	09243-09001	•PLUG	1	1	1	1	1	
10	24131-31000	DRIVE SHAFT	1	1	1	1	1	
11	24310-31821	GEAR SET, 1st driven	1	1	1	1	1	NT:37 See Note 2
12-1	24320-31822	GEAR SET, 2nd driven	1	1	1	1	-	NT:33 See Note 2 ~F.No.66399
12-2	24300-37810	GEAR SET, 2nd driven	-	-	-	1	1	NT:32 See Note 2
13-1	24330-31000	GEAR, 3rd driven	1	1	1	1	-	NT:30 ~F.No.66399
13-2	24330-37000	GEAR, 3rd driven	-	-	-	1	1	NT:29
14	24341-31000	GEAR, 4th driven	1	1	1	1	1	NT:27

NOTE 1 : When you use new countershaft assy, up to frame No.GT750-66399, please be sure to use 24221-37000, 24231-37000, 24300-37810 and 24330-37000 at the same time. See Note 2

NOTE 2 : This part consists of two gears per set.
Select one of two gears to fit existing transmission cluster.

E4

FIG.21 TRANSMISSION

Ref.No.	Part No.	Description	Q'ty					Remarks
			K	L	M	A	B	
15-1	24351-31000	GEAR, 5th driven	1	1	-	-	-	NT:24 to 24351-31001
15-2	24351-31200	GEAR, 5th driven	-	-	1	1	-	NT:25 to 24351-31201
15-3	24351-31201	GEAR, 5th driven	-	-	-	1	1	NT:25
16	09167-28001	WASHER	3	3	3	3	3	
17	08331-11289	CIRCLIP	3	3	3	3	3	from 09380-28002
18	09262-25024	BEARING	1	1	1	1	1	
19	08163-63050	BEARING	1	1	1	1	1	
20	08163-62040	BEARING	1	1	1	1	1	
21	09262-20036	BEARING	1	1	1	1	1	
22	09390-47003	C RING	2	2	2	2	1	
23	09390-62001	C RING	2	2	2	2	1	
24	09242-47001	PLUG	1	1	1	1	1	
25	09284-10002	OIL SEAL	1	1	1	1	1	
26	09283-32003	OIL SEAL	1	1	1	1	1	
27	09285-08003	OIL SEAL	1	1	1	1	1	
28	24751-31000	RETAINER, oil seal	1	1	1	1	1	
29-1	09280-63001	O RING	1	1	1	1	-	ID:62.8, d.:1.9
29-2	09280-64002	O RING	-	-	-	-	1	ID:64.5, d.:2.0
30	02122-06128	SCREW	4	4	4	4	4	
31	24870-31000	PLATER, oil reservoir	1	1	1	1	1	
32	02122-06128	SCREW	3	3	3	3	3	
33-1	24881-31000	PLATE, oil guide	1	1	-	-	-	to 24881-31001
33-2	24881-31001	PLATE, oil guide	-	-	1	1	1	
34	02112-05168	SCREW	3	3	3	3	3	
35	08321-21058	LOCK WASHER	3	3	3	3	3	

E5

FIG. 21 TRANSMISSION

Ref.No.	Part No.	Description	Q'ty					Remarks
			K	L	M	A	B	
36-1	27511-33600	SPROCKET, engine	1	1	Δ1	*1	-	NT:15 } *F.No.67347~ } Δ:OPT
36-2	27511-34000	SPROCKET, engine	Δ1	Δ1	1	1	-	NT:16 } } ~F.No.67346
36-3	27511-37001	SPROCKET, engine	-	-	-	-	1	NT:14
37	09180-25033	SPACER	1	1	1	1	1	25x32x10.7
38	09280-25001	O RING	1	1	1	1	1	
39	09140-24004	NUT	1	1	1	1	1	
40	09167-25007	WASHER	1	1	1	1	1	
41-1	27600-31015	CHAIN ASSY, drive	1	1	-	-	-	DID 50HDSS, 108ℓ from 27600-31013
41-2	27600-31014	CHAIN ASSY, drive	-	-	1	1	-	DID 50HDSS, 106ℓ, ~F.No.67346. to 27600-31017
41-3	27600-31017	CHAIN ASSY, drive	-	-	1	1	-	DID 50HDSS, 106ℓ
41-4	27600-31016	CHAIN ASSY, drive	-	-	-	1	-	DID 50HDSS, 104ℓ to 27600-31018
41-5	27600-31018	CHAIN ASSY, drive	-	-	-	-	1	DID 50HDSS, 104ℓ

E6