

FIG. 14 WATER PUMP

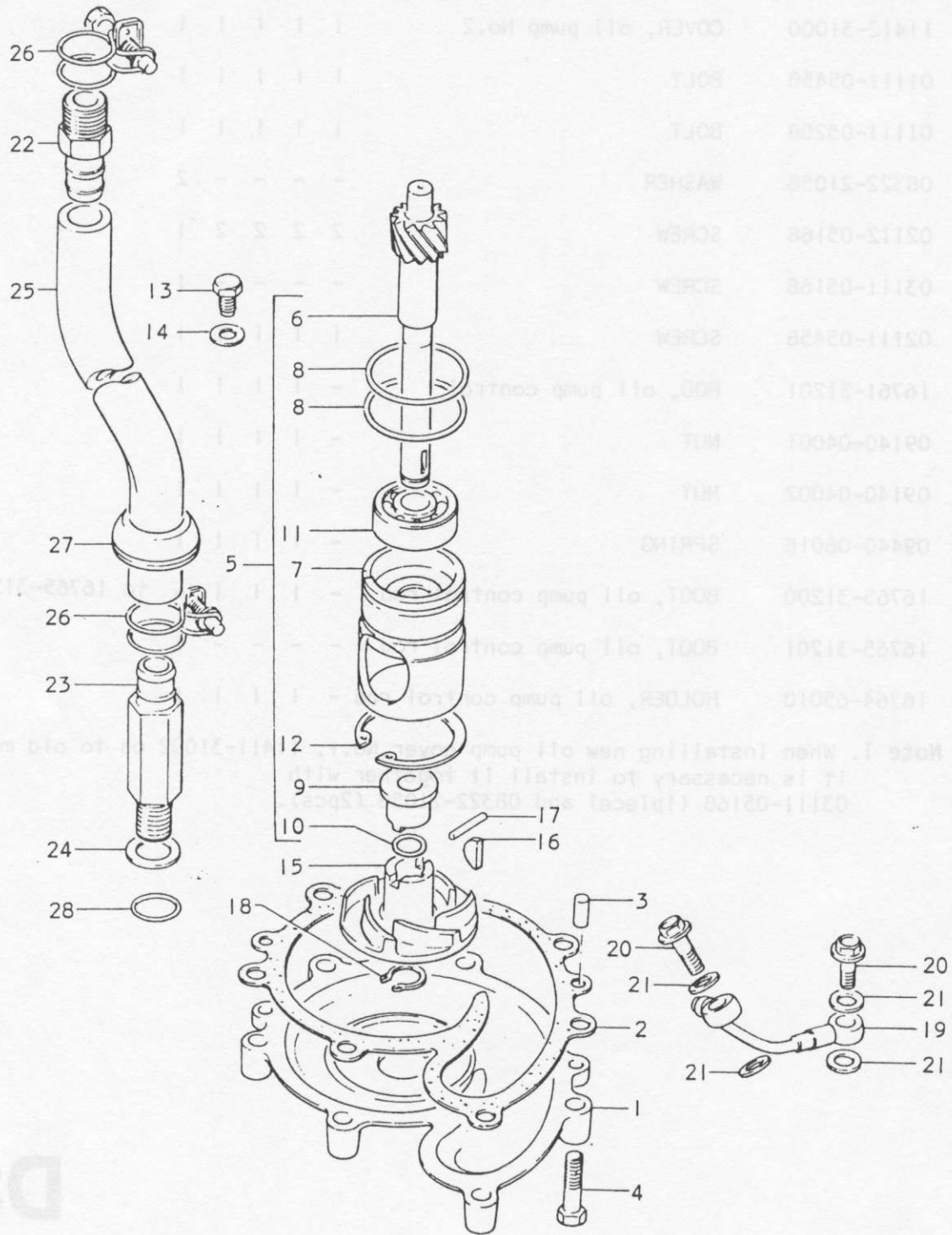

FIG.14 WATER PUMP

Ref.No.	Part No.	Description	Q'ty					Remarks
			K	L	M	A	B	
1	17411-31001	CASE, water pump	1	1	1	1	1	
2	17431-31002	GASKET, water pump case	1	1	1	1	1	from 17431-31001
3	06211-05103	DOWEL PIN	2	2	2	2	2	
4	01112-06258	BOLT	8	8	8	8	8	
5-1	17000-31819	WATER PUMP SET	1	-	-	-	-	to 17400-31830
5-2	17400-31830	WATER PUMP SET	1	1	1	1	1	F.No.37158~
6-1	17461-31000	·SHAFT, driven	1	-	-	-	-	to 17461-31001
6-2	17461-31001	·SHAFT, driven	1	1	1	1	1	F.No.37158~
7	17400-31809	·DRIVEN SHAFT HOLDER SET	1	1	1	1	1	
8	09280-33001	·O RING	2	2	2	2	2	32.6x1.9
9	17476-31000	·SEALING SEAT	1	1	1	1	1	
10	09280-10001	·O RING	1	1	1	1	1	9.6x1.3
11	08110-62000	·BEARING	1	1	1	1	1	
12	09381-40001	CIRCLIP	1	1	1	1	1	
13	09135-06002	BOLT	1	1	1	1	1	
14	08322-21068	WASHER	1	1	1	1	1	
15	17466-31001	IMPELLER, water pump	1	1	1	1	1	from 17466-31000
16	08341-31039	KEY	1	-	-	-	-	
17	09205-03012	PIN	1	1	1	1	1	F.No.37158~
18	08331-11109	CIRCLIP	1	1	1	1	1	
19	17620-31030	PIPE, air breather	1	1	1	1	1	
20	09360-06003	UNION BOLT	2	2	2	2	2	
21	09168-06002	GASKET	4	4	4	4	4	6x11.8x1.5

D4

FIG.14 WATER PUMP

Ref.No.	Part No.	Description	Q'ty					Remarks
			K	L	M	A	B	
22	09362-16001	UNION, water by-pass hose (1)	1	1	1	1	1	
23	17631-31000	UNION, water by-pass hose (2)	1	1	1	1	1	
24	09168-14004	GASKET	1	1	1	1	1	
25	09343-13004	HOSE, water by-pass	1	1	1	1	1	
26-1	09400-00001	CLAMP	2	-	-	-	-	to 09400-22301
26-2	09400-22301	CLAMP	-	2	2	2	2	
27	09308-18005	GROMMET	1	1	1	1	1	
28	09280-12002	O RING	1	1	1	1	1	

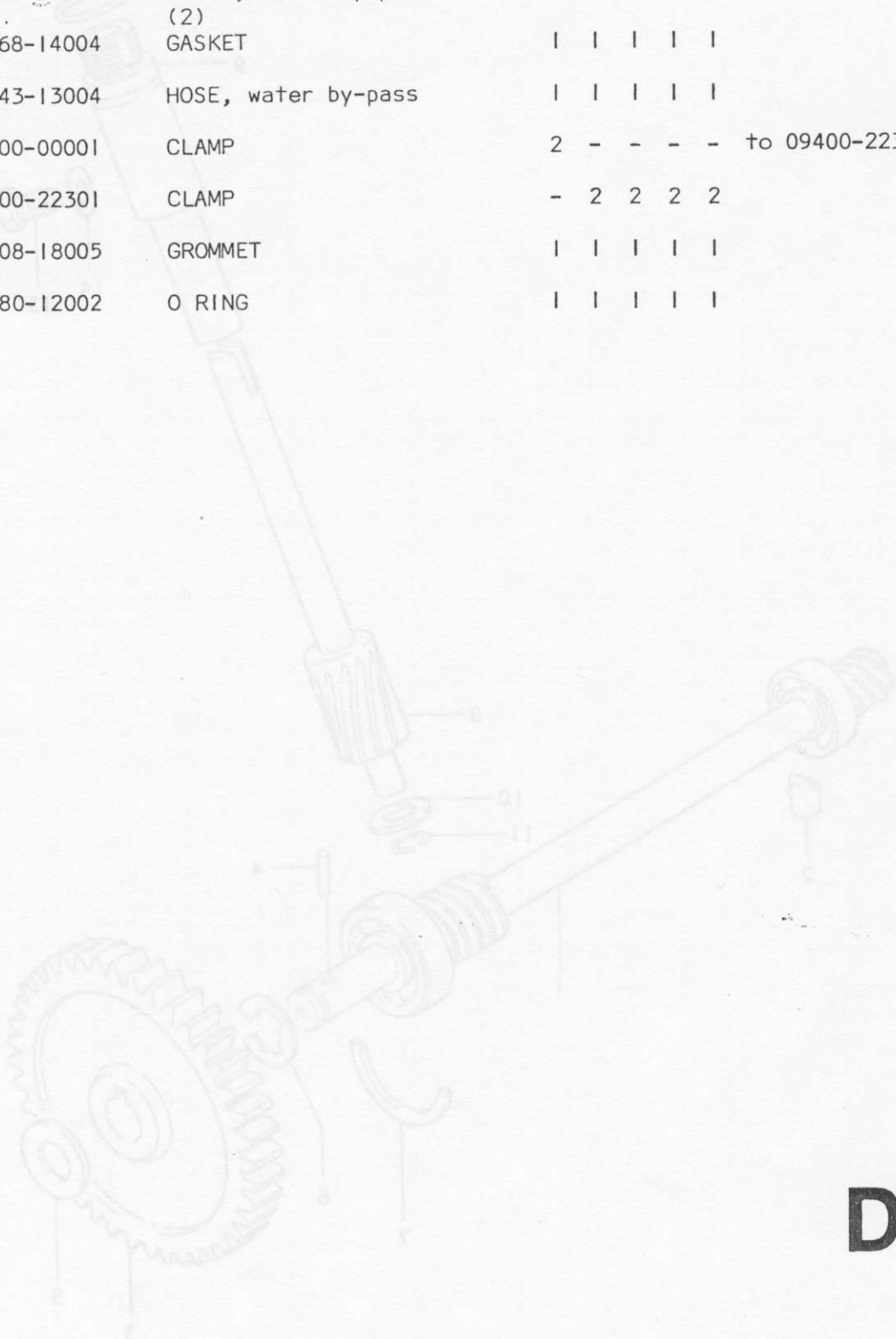

D5