

FIG.13 OIL PUMP

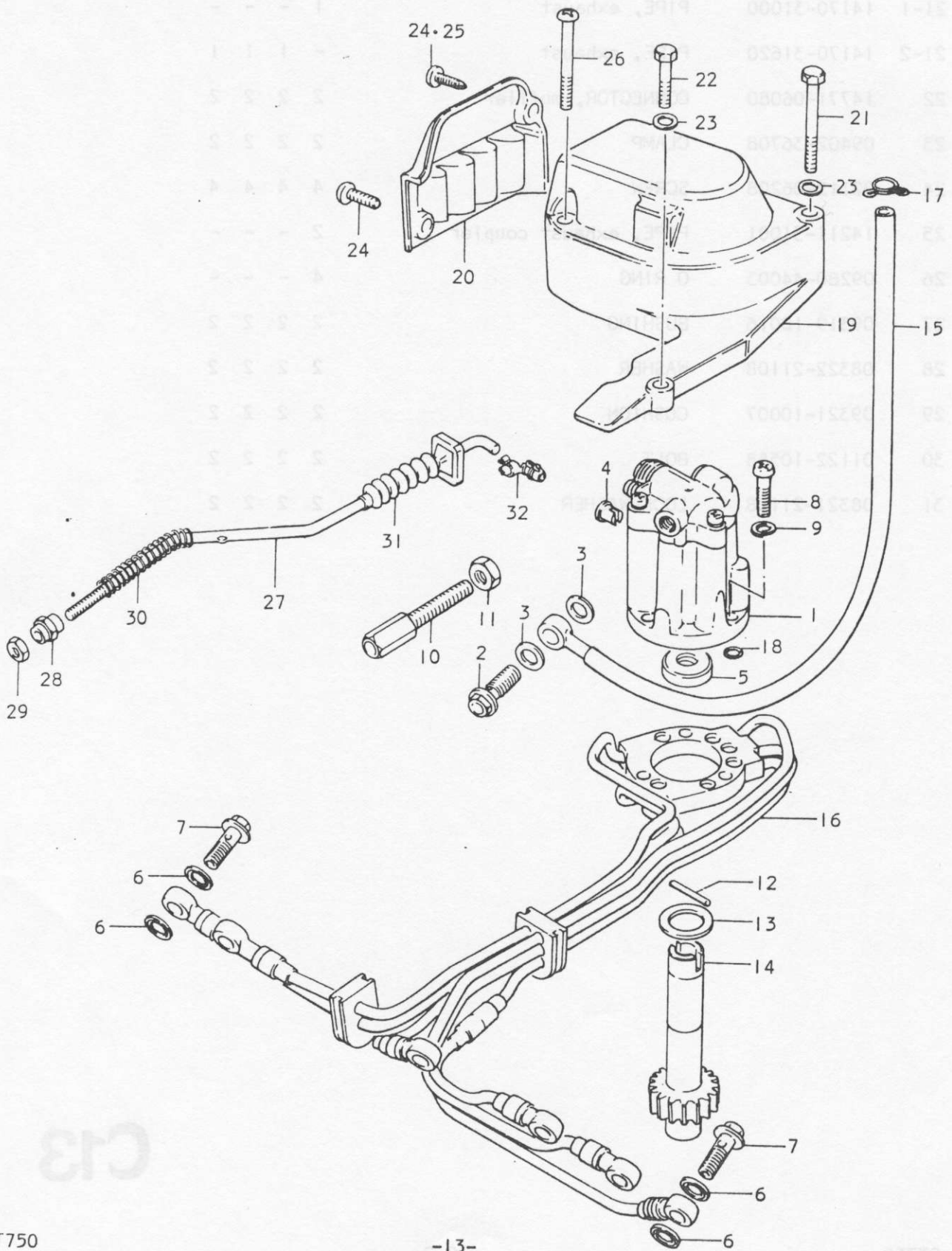

FIG.13 OIL PUMP

Ref.No.	Part No.	Description	Q'ty					Remarks
			K	L	M	A	B	
1-1	16100-31002	PUMP, oil	1	-	-	-	-	from 16002-31804
1-2	16100-31201	PUMP, oil	-	1	1	-	-	from 16100-31831
1-3	16100-31202	PUMP, oil	-	-	-	1	1	from 16100-31201
2	09360-06003	UNION BOLT	1	1	1	1	1	6x16
3	09168-06002	GASKET	2	2	2	2	2	6x11.8x1.5
4	16292-03110	TERMINAL, cable	1	-	-	-	-	
5	09285-08002	OIL SEAL	1	1	1	1	1	
6	09168-06002	GASKET	12	12	12	12	12	6x11.8x1.5
7	09360-06003	UNION BOLT	6	6	6	6	6	6x16
8	02111-05257	SCREW	3	3	3	3	3	
9	08321-21058	LOCK WASHER	3	3	3	3	3	
10	09119-08014	BOLT	1	-	-	-	-	
11	08312-11088	NUT	1	-	-	-	-	
12	09261-03010	PIN	1	1	1	1	1	
13	08211-14221	THRUST WASHER	1	1	1	1	1	
14	16331-31001	SHAFT, oil pump driven	1	1	1	1	1	NT:15
15	16810-31200	HOSE, oil No.1	1	1	1	1	1	from 16810-05031
16	16820-31031	HOSE, oil No.2	1	1	1	1	1	
17-1	09400-10301	CLAMP	1	1	-	-	-	from 09400-00107
17-2	09401-08401	CLAMP	-	-	1	1	1	
18	09280-03002	O RING	6	6	6	6	6	

D2

FIG.13 OIL PUMP

Ref.No.	Part No.	Description	Q'ty					Remarks
			K	L	M	A	B	
19-1	11411-31001	COVER, oil pump No.1	1	1	1	1	-	Aluminum to 11411-31002, See Note 1. PLASTICS
19-2	11411-31002	COVER, oil pump No.1	-	-	-	1	1	
20	11412-31000	COVER, oil pump No.2	1	1	1	1	1	
21	01111-05458	BOLT	1	1	1	1	1	
22	01111-05208	BOLT	1	1	1	1	1	
23	08322-21058	WASHER	-	-	-	-	2	
24	02112-05168	SCREW	2	2	2	2	1	
25	03111-05168	SCREW	-	-	-	-	1	
26	02111-05458	SCREW	1	1	1	1	1	
27	16761-31201	ROD, oil pump control	-	1	1	1	1	
28	09140-04001	NUT	-	1	1	1	1	
29	09140-04002	NUT	-	1	1	1	1	
30	09440-06016	SPRING	-	1	1	1	1	
31-1	16765-31200	BOOT, oil pump control rod	-	1	1	1	-	to 16765-31201
31-2	16765-31201	BOOT, oil pump control rod	-	-	-	-	1	
32	16764-65010	HOLDER, oil pump control rod	-	1	1	1	1	

Note 1. When installing new oil pump cover No.1, 11411-31002 on to old models, it is necessary to install it together with 03111-05168 (1piece) and 08322-21058 (2pcs).



D3